



# MaxLite® LED Slim Flush Mount

## General Safety Information

READ AND FOLLOW ALL SAFETY INSTRUCTIONS

### ⚠ WARNING

**WARNING:** Carefully read and understand the information given in this instruction sheet before beginning the assembly and installation.

Failure to do so could lead to electric shock, fire, or other injuries which could be fatal.

- Ensure the electricity to the fixture you are working on is shut off.
- Risk of fire or electric shock. Fixture must be installed by a qualified electrician.
- To prevent wiring damage or abrasion, do not expose wiring to edges of sheet metal or other sharp objects.

**NOTICE:** This device complies with Part 15 of the FCC Rules. Operation is subject to the following two conditions: (1) this device may not cause harmful interference, and (2) this device must accept any interference received, including interference that may cause undesired operation. These limits are designed to provide reasonable protection against harmful interference in a residential installation. This equipment generates, uses and can radiate radio frequency energy and, if not installed and used in accordance with the instructions, may cause harmful interference to radio communications. However, there is no guarantee that interference will not occur in a particular installation. If this equipment does cause harmful interference to radio or television reception, which can be determined by turning the equipment off and on, the user is encouraged to try to correct the interference by one or more of the following measures: Reorient or relocate the receiving antenna, increase the separation between the equipment and the receiver, connect the equipment into an outlet on a circuit different from that to which the receiver is connected, and consult the dealer or an experienced radio/TV.



*Pictures are for illustration purposes only.  
Your model may vary.*

## Installation Instructions – Installation with J-Box: 5.5", 7", 9", 12" fixtures

**⚠ Safety Precautions** WARNING: Make sure the POWER IS TURNED OFF at the source to the in which you are installing the product.

1. Remove the mounting plate from the back of the fixture.
2. Fasten mounting plate to with mounting screws.
3. Select desired color temperature (CCT) using switch.
4. Wire the surface mount, white-white, black-black and green to ground wires.. Once wire connections are made, secure each with a wire nut and push up onto the J-Box.
5. Align spring clips on the fixture with mounting plate.
7. Carefully tuck wires into J-Box, and raise the surface mount up into place.
8. Caulk around the mounting surface edge with silicone sealant.

# MaxLite® LED Slim Flush Mount



## Installation Instructions – Installation with J-Box: 15" fixture

**⚠ Safety Precautions** WARNING: Make sure the POWER IS TURNED OFF at the source to the in which you are installing the product.

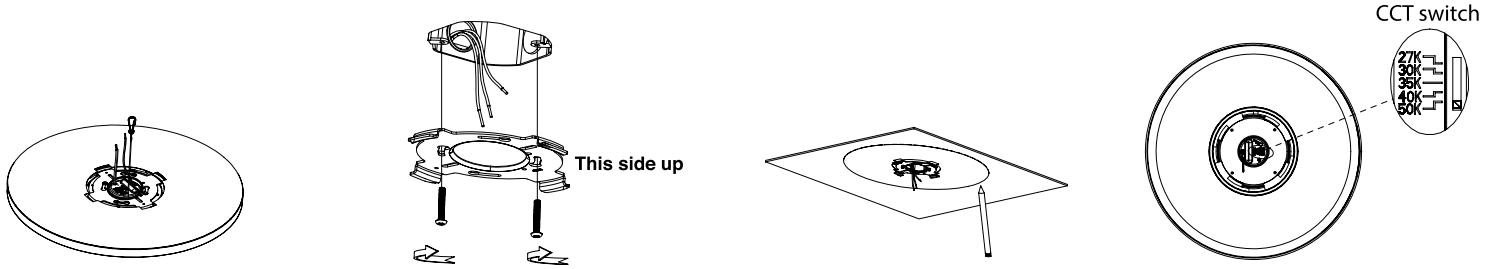

1. Remove the mounting plate from the back of the fixture.
2. Fasten mounting plate to with mounting screws.
3. Insert paper template into the installation bracket and rotate the paper. Use a pen to draw circles according to the outer size path of the template
4. Select desired color temperature (CCT) using switch.

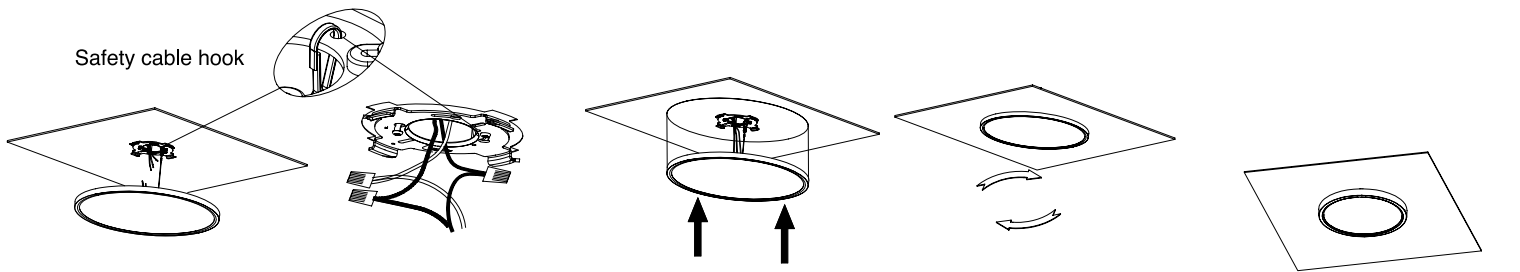

5. Fix the safety cable hook with the bracket hole. Wire the surface mount, white-white, black-black and green to ground wires. Once wire connections are made, secure each with a wire nut.
6. Carefully tuck wires and safety cable into the junction box. Align the lamp with the pre-marked path line, then rotate the luminaire clockwise to securely snap it into the mounting bracket.
7. Caulk around the mounting surface edge with silicone sealant.

## Warranty Information

Maxlite Inc. warrants its products for a minimum period of **FIVE (5)** years from the earlier of the actual installation date or 90 days after the original date of purchase from a Maxlite authorized distributor/dealer (the "Warranty Period"), as follows: If a Product fails to operate during the Warranty Period as a result of defects in materials or workmanship, Maxlite will, at its option, repair it, replace it with the same or like Product.

Please refer to Maxlite's website (at <http://maxlite.com/resources/warranties>) for the complete coverage details as well as the terms and conditions of our warranty.

### Limitation of Liability

THIS WARRANTY IS EXCLUSIVE, AND IS THE SOLE REMEDY FOR ANY AND ALL CLAIMS, WHETHER IN CONTRACT, IN TORT OR OTHERWISE ARISING FROM THE FAILURE OF PRODUCT AND IS IN LIEU OF ALL OTHER WARRANTIES, EXPRESS OR IMPLIED, INCLUDING ALL WARRANTIES OF MERCHANTABILITY OR FITNESS FOR A PARTICULAR PURPOSE, WHICH WARRANTIES ARE HEREBY EXPRESSLY DISCLAIMED TO THE EXTENT PERMITTED BY LAW AND, IN ANY EVENT, SHALL BE LIMITED TO THE WARRANTY PERIOD SPECIFIED ABOVE. THE LIABILITY OF MAXLITE SHALL BE LIMITED TO THE TERMS OF THE EXPRESS WARRANTY SET FORTH HEREIN. IN NO EVENT WILL MAXLITE BE LIABLE FOR ANY SPECIAL, INCIDENTAL OR CONSEQUENTIAL DAMAGES INCLUDING, WITHOUT LIMITATION, DAMAGES RESULTING FROM LOSS OF USE, PROFITS, BUSINESS OR GOODWILL, LABOR COSTS, REMOVAL OR INSTALLATION COSTS, WHETHER OR NOT MAXLITE HAS BEEN ADVISED OF THE POSSIBILITY THEREOF. UNDER NO CIRCUMSTANCES SHALL MAXLITE'S ENTIRE LIABILITY FOR A DEFECTIVE PRODUCT EXCEED THE PURCHASE PRICE OF THAT PRODUCT (EXCLUDING LABOR WARRANTY COVERAGE WHERE SPECIFICALLY OFFERED BY MAXLITE). WARRANTY SERVICES PROVIDED UNDER THESE TERMS AND CONDITIONS DO NOT ENSURE THE UNINTERRUPTED OPERATION OF PRODUCTS; MAXLITE SHALL NOT BE LIABLE FOR DAMAGES CAUSED BY ANY DELAYS INVOLVING WARRANTY SERVICE.

This Warranty gives you specific legal rights and you may also have other rights that may vary from state to state. Because some states or jurisdictions do not allow the exclusion or limitation of liability for consequential or incidental damages, such limitation may not apply to you.